



Garden care is our business - People are our strength

- Fall Clean Up 2
- Cultivation and Weeding
- Pruning & Hedge Trimming
- Organic Planet: 3
  - Organic Fertilizing for Turf and Gardens
  - Core Aeration
  - Slit Seeding
  - Curbside Composting
- Weekly Turf Maintenance 4
- Leaves Service
- Environmental & Smart Water Resource Management
  - Spring Activation & Water Audit
  - Irrigation System Close Out
  - Green Roofs – the Sky’s the Limit
- Landscaping & Design Services 5
  - Garden Design
  - Stone Masonry
- Planting Services 6
  - Trees & Shrubs & Perennials
  - Annuals & Bulbs
  - 4-Season Urn & Theme Displays
- Management 7
- Management 8

## GARDEN SERVICES

Lawrence Park Garden Care has grown to become one of Toronto’s most admired and respected garden maintenance and landscape design/build companies, providing an extensive variety of services from simple weekly garden maintenance, to a full range

of “Award Winning” specialized gardening, hardscaping, landscaping and design solutions. If you are considering making changes to your services this year, please give us plenty of notice so that we may meet your expectations.

## Lawrence Park Garden Care – 2010 Winner

### Landscape Ontario Awards of Excellence for Residential Landscape Maintenance and Landscape Container Gardening

For the third consecutive year, LPGC has been recognized by our governing body, Landscape Ontario. From thousands of companies that provide landscape services in Ontario, we are proud to receive this recognition for the excellent results we have achieved in our clients’ gardens.



Landscape Design and Construction projects, including examples of our work with natural stone merged with outstanding Planting Design. Our Land-

scape Design staff or our Horticultural Service Reps will be happy to advise you on the best way we can help your home and gardens look their best.

Our previous awards also highlighted our

## Spring Clean Up

This service begins in late March/early April and depending on the variety of plants in your garden, continues through to the end of April. Every garden will need some level of clean up and preparation for the growing season.

This service typically includes raking and/or dethatching your lawn (to remove winter’s debris), and demounding your Roses and Rhododendrons. Our dethatching machines remove dead grass and snow mold to allow our fertilizers and grass seed to penetrate the surface grass layer to the soil. It is strongly recommended that, at the very least, your lawn be given a thorough raking so that added nutrients and seed will reach the soil below.

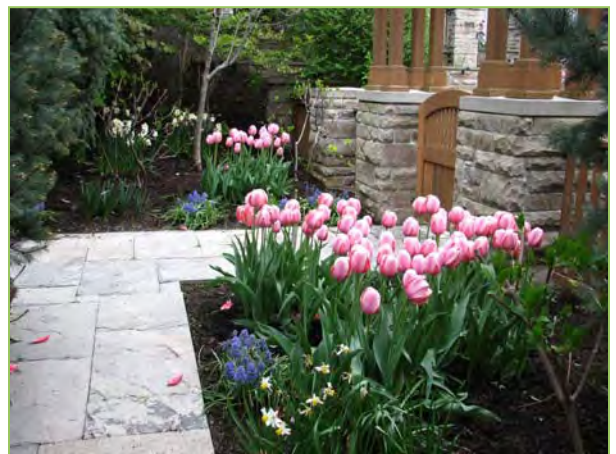



## Fall Clean Up

Autumn in the Park is one of our most beautiful seasons. It's also one of the busiest times of the year for us here at Lawrence Park Garden Care. Starting the first week of November and continuing through the month, we tackle the big end-of-season jobs that mark the last days of autumn. Beyond leaf removal our gardens often need winterizing in order to protect and preserve winter-sensitive plants.



## Cultivation and Weeding

We usually recommend that your garden beds be cultivated on a bi-weekly basis, though some gardens have different needs. This service starts in April and continues through to the first frost. Cultivation is done using hoes to till the top 2-3 inches of soil. It is primarily done for aesthetic reasons in conjunction with removing weeds and has the added benefit of aerating the soil.

Special services, like Rose pruning and care,

will begin with early Spring Clean Up when all Floribundas and hybrid tea Roses are cut back. Grandifloras and other climbers are cut back slightly differently and all pruning stops in August to allow Roses to harden off for winters.

**Organic treatment of Roses and other plants is provided throughout the season as an additional service.**



## Pruning & Hedge Trimming

### Selective Pruning

For a number of years LPGC has encouraged selective pruning and we've seen some very positive results: the health and vigor of the renovated shrubs have been enhanced and according to our clients it has improved the aesthetic appearance of their gardens overall. This move away from the traditional, formal garden has been embraced more and more over the last few years. Still, both formal and informal gardens have their place, and we will always strive to meet your aesthetic goals for your home landscape.

### Hedge Trimming

This service is provided when needed and often starts during the dormant season in early March. In general spring flowering shrubs like Spirea and Forsythia are trimmed hard after their flowering and perhaps once or twice more during the growing season. Late flowering shrubs like Hydrangeas are cut back first thing in the spring. Evergreens are generally cut once in early spring and then again in summer.

## ORGANIC PLANET



### Curbside Composting

During fall leaf clean up, Lawrence Park Garden Care's curbside composting service has completely eliminated curbside dumping of leaves. Our truck vacuums, mulches and removes leaves right from your curb.



Lawrence Park Garden Care's trio of turf services are our pro-active answer to pesticide use in lawns. We are always looking for

the best new organic products that produce beautiful, chemical free turf. This is our 3-step process to an organically-healthy lawn.

### Step 1 - Organic Fertilizing for Turf and Gardens

In the past Lawrence Park Garden Care has used water-soluble quick release fertilizers combined with spot spraying for weeds. Now, due to environmental concerns and exciting new product developments, we only use organic fertilizers.

This means a few things. If your lawn is already healthy, you will continue to have strong turf without the use of any synthetic fertilizers and pesticides. If your turf isn't particularly healthy, there will be a definite improvement in your soil's physical chemis-

try, plus a revitalization of the existing turf with the application of our organic fertilizer.

Every garden benefits from adding Compost and Fertilizer for Plants. Compost builds healthy soil by providing decayed organic matter that retains moisture and oxygen. We recommend combining this in spring or fall with a slow-release organic fertilizer that enriches the soil with the balanced spectrum of nutrients and minerals that plants need to thrive.

### Step 2 - Core Aeration

You will be familiar with this service if you've played golf in the early spring and early fall and have seen the greens studded with small holes. Aeration is the perforation of your lawn to allow better movement of air, water and nutrients through the soil below.

It allows both water and fertilizers to penetrate the soil more easily and seed to germinate better and faster.

This service is primarily done twice a year, with either Spring Clean Up or a Slit Seeding.

### Step 3 - Slit Seeding

Our new slit seeding process does 2 great things at the same time:

1. Loosens the soil just below the surface.
2. Inserts the grass seed beneath the surface of your lawn.

The overwhelming result is a healthier, thicker lawn and reduced space for weeds to grow. Additionally, it is better for the environment because slit seeding also uses little or no peat moss, which reduces demand on fragile peat bogs and marshland.



We do the seeding twice a year: once in late April to mid-June and once in late August to late September. Lawrence Park tends to be a tree covered community; therefore our grass mixes are usually high in shade tolerant seed. The success of your newly seeded lawn depends on consistent watering for the first weeks as the seeds germinate and develop. Information will be provided about care requirements as needed.

## Weekly Turf Maintenance

This is a weekly service that begins in May and continues to the end of October. It includes cutting and trimming your lawn and cleaning up all hard surfaces.

If you have any specific requests, like putting all grass clippings in your composter or leaving them on the lawn, please be sure to tell your Garden Care Supervisor or let us know by filling out the "Suggestion, Comment or Request" Sheets included with your monthly bill.

Please note that this service is not designed to be your total garden plan; there will always be additional jobs like Hard Surface Treatments, leaf clean up (see Leaves Service, at right), and removing fallen limbs, etc., which are provided at an additional fee.

## Leaves Service

This is a weekly service in October. It includes removing all leaves and fallen debris on grass and hard surfaces. It is not included in the cost of Weekly Turf Maintenance.

## ENVIRONMENTAL & SMART WATER RESOURCE MANAGEMENT

With Lawrence Park Garden Care's Smart Water Management Service, you will see your garden go from good to spectacular. Along with improved appearance, our service will provide balanced water conservation on your property. From consultation to modification, our commitment to great service will provide you with a worry-free irrigation system that will keep your garden looking beautiful all season long.



## Spring Activation & Water Audit

This begins in the spring with a full site inspection of your irrigation system. Our team of Certified Irrigation Technicians (CITs) will check all controllers, heads and risers to identify any problems and initiate solutions.

## Irrigation System Close Out

Timing is everything when it comes to shutting down your irrigation system at the end of the season. Turning off the water too early means your trees and shrubs may not get their last drink of water before winter. Shutting down too late risks stressing seals, valves and pipes. Our experienced Water Management team will make sure both these needs are well balanced.

## Green Roofs — the Sky's the Limit

Offering Green Roof services is another way that LPGC is proving our commitment to innovative environmental gardening practices. We are excited to now offer the design and installation of Green Roofs. The roofs can reduce energy consumption by insulating and cooling buildings, producing oxygen, reducing and purifying storm runoff. They also create aesthetic green and flowering environments to be enjoyed, even while being viewed from a higher level of your house.

Almost any roof can add something special to your property by becoming a Green Roof, whether it is your house, pool house, playhouse or shed. A maintenance schedule will be developed as an integral part of the warranty that will ensure years of sustainable growth.



# LANDSCAPING & DESIGN SERVICES

Creating a great garden is a life long pleasure, but getting started can be daunting. Whether it's a complete makeover or simply replacing and rearranging a few shrubs or trees, our Landscape Design staff brings a breadth of knowledge and experience to this work that will allow you to enjoy your garden at its best.

## Garden Design

If you are thinking about making changes in your gardens, one of our professional designers can help you get started. We'll meet you at your home to discuss your ideas and begin to create a custom plan for your new landscape.

Our garden designs do more than just improve the appearance of your house; they draw you outdoors during the growing season, increasing the pleasure you feel whenever you are in this part of your home. Our love of gardens is something we like to share, as we create a view to be enjoyed from inside, even during the long winter months.

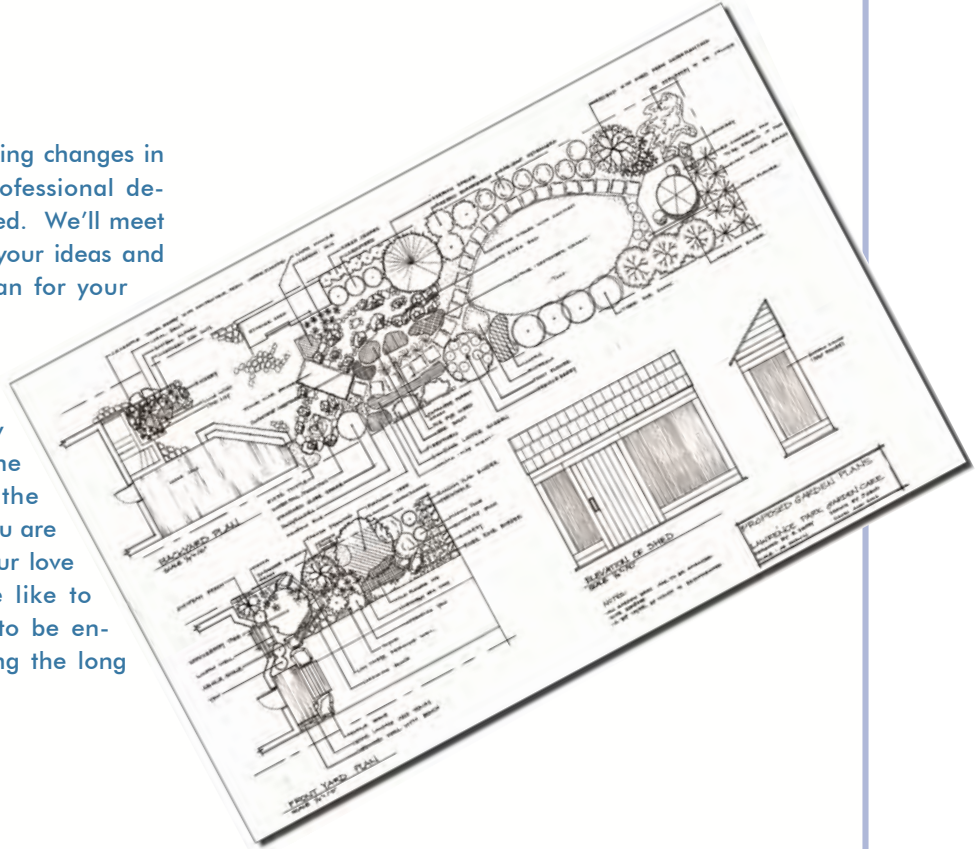

## Stone Masonry

Great stonework can be incorporated into almost any landscape. It can be a new patio for entertaining, or a new landing and steps at your front entrance to enhance the experience of 'arrival'. This age-old skill of working stone creates structure to add elegance and definition to your property.

An investment in good quality stone masonry is money well spent on your home landscape, and a great beginning to the establishment of a beautiful garden. LPGC has years of experience in this field and we would be happy to discuss designs and materials with you.



## 4-Season Urn & Theme Displays

Everyone has their favourite time of year.

Seasonal Urn Displays have become a large part of the first impression of your home and a reflection of the season. Working closely with our clients to address colour, form and design, we work hard to help your vision become a reality.

Our design team looks forward to another year of providing Award-winning planters and seasonal themed garden displays.

## Trees & Shrubs & Perennials

Stately trees, flowering shrubs and a variety of perennials can work together to create a beautiful garden that will be enjoyed for years. The design “key” is understanding how to use them together effectively. As designers, we can help with a layout for your garden that will meet the growing requirements for your new plants, with attention to bloom times that will span all four seasons.

We believe that more emphasis should be

placed on the initial preparation of the site before planting your new trees and shrubs. Our focus on this means that we have almost no recall on either plant materials or design. We carefully select only proven high quality trees and shrubs from a few established nurseries.

Whether your taste runs to modern, sculptural shapes or to lush colours and textures, let us help you build a garden that will bring you and your family many years of joy.

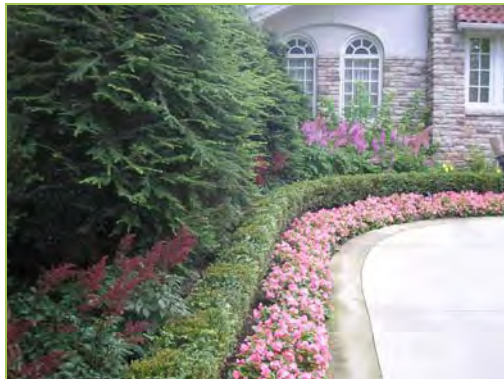

## Annuals & Bulbs

Annuals are by far the most dependable and durable producers of colour and texture. From Impatiens to Dahlias to Pansies, these are the plants with petal power: they will bloom from early spring through late fall in an infinite variety of colours, shapes and sizes to suit every garden type.

Whether it's a few baskets or urns, or an extensive display in your garden, annuals are guaranteed to brighten up your home. Even the most devoted perennial gardeners use select annuals to cheer up a troublesome shady spot, or to fill in a gap between the bloom times of their favourite plants. There is nothing better than colourful annuals to provide the best introduction to your home, particularly around the entrance.

Oddly enough, one of the last gestures in your garden every year is choosing and planting your spring bulbs. Flowering bulbs help to kick off the winter blahs with a burst of colour. We will help you find the plants, colours and textures that will make spring one of your favourite seasons.

A client's Canadian Winter  
Olympic Display

# MANAGEMENT

## Garden Services



**Craig Hutchinson – President / Service Manager**

Craig has 28 years experience in the landscaping industry, working exclusively in Lawrence Park for the past twenty years. In addition to practical experience, he is a Certified Horticulturist and takes pride in his knowledge of gardening, plant materials and design. An active Lawrence Park community member, Craig looks over all the properties he serves in our neighborhood and treats each one as if it were his own.

Email [craig@lawrenceparkgardencare.com](mailto:craig@lawrenceparkgardencare.com)



**Rita Devgan – Horticultural Service Rep**

As a graduate of Landscape Architecture from U of T, Rita has been working in the landscape industry for over 20 years. She brings her experience in Design Build to LPGC’s Maintenance Department where she has a mandate to continue our reputation as a provider of excellent garden care. You may see Rita enjoying the beauty of your garden by capturing it in early- morning photographs.

Email [rita@lawrenceparkgardencare.com](mailto:rita@lawrenceparkgardencare.com)



**Darren Young – Horticultural Service Rep**

Darren is entering his 17th year at Lawrence Park Garden Care. He is a shining example of an employee who has worked his way up through the ranks. He has successfully transitioned to his current role in the Service Department and looks forward to continuing in the 2010 Season.

Email [darren@lawrenceparkgardencare.com](mailto:darren@lawrenceparkgardencare.com)



**Brent Donaldson – Horticultural Service Rep**

Brent is looking forward to his 3rd season with Lawrence Park Garden Care. With more than 13 years experience in the horticulture industry, Brent brings with him an extensive knowledge of landscape design, gardening and customer service skills.

Email [brent@lawrenceparkgardencare.com](mailto:brent@lawrenceparkgardencare.com)

**John Backus, Kenny Wan, Jeffrey Kahn, Aaron Shore - Garden Care Supervisors**

John, Kenny, Jeffrey, and Aaron collectively have more than thirty years of garden care experience. They have all completed educational programs through Landscape Ontario and are experienced team leaders who work hard to meet the individual needs of every LPGC client.



## Accounting



**Ross Irving - Accounts Receivable**

For questions about your Invoice or Payment options. Email Ross: [ar@lawrenceparkgardencare.com](mailto:ar@lawrenceparkgardencare.com)

## Administration



**Ivy Taylor - Office Manager**

Ivy is entering her 8th year with LPGC. Ivy and her Admin team, Edward Yap and Barbara Noad are involved in all areas of Company administrative support. Email Ivy: [ivy@lawrenceparkgardencare.com](mailto:ivy@lawrenceparkgardencare.com)

## MANAGEMENT

### Landscape & Design Services



#### **Raina Mullen – Landscape Design Manager (Design Team)**

Raina, a graduate of the Humber College Landscape Technician course, has been heading up the design team for 13 years. She is an experienced landscape designer, who, along with designing, is kept busy in the neighbourhood working with the landscape team on installations and estimates.

Email [raina@lawrenceparkgardencare.com](mailto:raina@lawrenceparkgardencare.com)



#### **Allan Sinclair – Planting Designer (Design Team)**

Having studied Landscape Architecture at the University of Toronto, AI has a cutting edge vision for the future of design. He is always looking for new and inventive ways for clients to receive far more than what they initially expected. Planters, annuals, bulbs, design and construction are part of his portfolio in our landscape department.

Email [allan@lawrenceparkgardencare.com](mailto:allan@lawrenceparkgardencare.com)



#### **Jacquie Geno – Landscape Designer (Design Team)**

Jacquie is in her 5th year with LPGC. She is a graduate of the Humber College Landscape Design Program and is our resident Draftsperson, working closely with Raina, AI and Nancy to meet the expectations of our clients. Jacquie is looking forward to an exciting new season!

Email [jacquie@lawrenceparkgardencare.com](mailto:jacquie@lawrenceparkgardencare.com)



#### **Nancy Weiss – Planting Coordinator (Design Team)**

Nancy is a passionate gardener and has completed several Ryerson Gardening courses. With many years of hands on experience, Nancy works with our clients to help create unique gardens throughout Lawrence Park and is our Green Roof contact person.

Email [nancy@lawrenceparkgardencare.com](mailto:nancy@lawrenceparkgardencare.com)



#### **Jim Cape and Larissa Stipetic - Landscape Supervisors**

Jim is a Humber College Landscaping and Design graduate and is one of Lawrence Park's resident Horticulturists. Jim has over 20 years of landscaping experience including expert pruning skills, stone, timberwork, and planting know-how.



Larissa has been with LPGC for 12 years and has a reputation for attention to detail and non-stop hard work. She has completed her certification in Horticulture from Humber College and brings her knowledge and dedication to design into the gardens she attends.



LAWRENCE PARK  
Garden Care Ltd.

[www.lawrenceparkgardencare.com](http://www.lawrenceparkgardencare.com)

Ph 416.481.1888  
Fax 416.631.0200  
3960 Chesswood Dr.  
Toronto, ON M3J 2W6